

DANIELS CROSSING

6900 Daniels Parkway Fort Myers, FL 33912



PROPERTY HIGHLIGHTS

- Publix-anchored neighborhood center at the signalized intersection of Daniels Parkway and Six Mile Cypress
- 90,000+ Drivers traverse the intersection daily
- Fort Myers has consistently been recognized as one of the top growing cities in the United States over the past several years
- Daytime traffic includes 18 nearby office buildings and nearly 2,000 hotel rooms
- Adjacent to Gulf Coast Medical Center, a 356-bed medical complex that will add another 268 beds in 2021

DEMOGRAPHICS 3 MILES 5 MILES 7 MILES

	3 MILES	5 MILES	7 MILES
Total Households	21,852	62,757	102,652
Total Population	45,909	135,376	233,972
Average HH Income	\$90,377	\$85,581	\$86,733

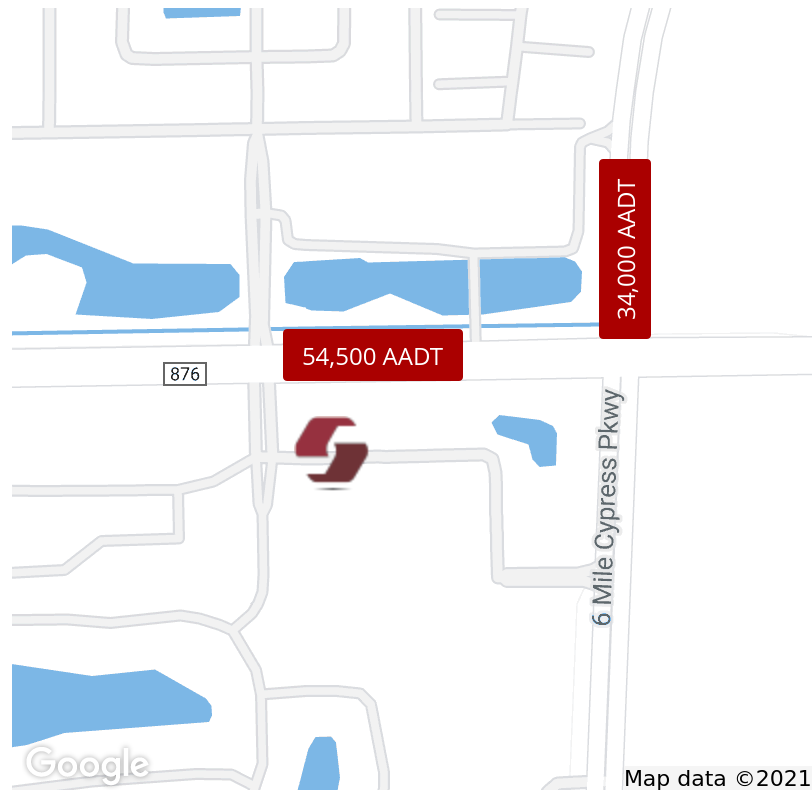

The Sembler Company | 800.940.6000 | sembler.com

JESSICA MORENO

727.344.8134

JESSICA.MORENO@sembler.com

Although the Sembler Company has obtained the information contained herein from sources it believes to be reliable, and believes the information to be correct, no representations or warranties, express or implied, are made as to the accuracy or reliability of this information. Any references to square footage or age are approximate only. The recipient bears sole responsibility for verification of the accuracy of the information contained herein and bears all risk for any inaccuracies. The Sembler Company shall have no liability or responsibility to any party for any loss or damage arising from reliance by any party on the information contained herein. Site plans subject to change.

DANIELS CROSSING

6900 Daniels Parkway Fort Myers, FL 33912

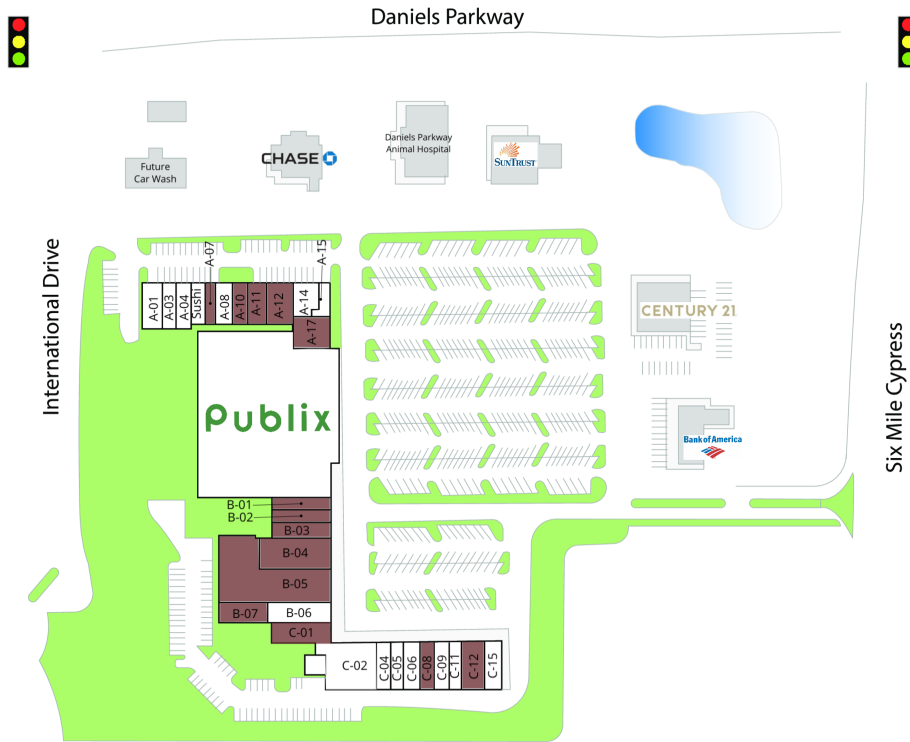

SITE PLAN & AVAILABILITY

A-01	Stadium Cleaners	2,080 SF	B-02-03	AVAILABLE	3,010 SF
A-03	NY Pizza	1,300 SF	B-04	AVAILABLE	4,170 SF
A-04	Subway	1,170 SF	B-05	AVAILABLE	11,316 SF
A-05	Sushi	1,810 SF	B-06	Quest Diagnostics	2,565 SF
A-07	AVAILABLE	905 SF	B-07	AVAILABLE	1,922 SF
A-08	Le Nails & Spa	1,810 SF	C-01	AVAILABLE	1,720 SF
A-10	AVAILABLE	905 SF	C-02	Potts Sports Cafe	3,879 SF
A-11	AVAILABLE	905 SF	C-04	Run Shoppe	1,065 SF
A-12	AVAILABLE	1,810 SF	C-05	UPS Store	1,065 SF
A-14	Duck Donuts	1,772 SF	C-06	Dr. Shelley King	2,130 SF
A-15	Three Pepper Burrito	1,650 SF	C-08	AVAILABLE	1,420 SF
A-17	AVAILABLE	1,000 SF	C-09	KM Hair Designs	1,420 SF
AA	Publix	48,890 SF	C-11	Ed Klopfer School of RE	1,092 SF
B-01	AVAILABLE	1,720 SF	C-12	AVAILABLE	4,970 SF
B-02-03	AVAILABLE	3,010 SF	C-15	School of Rock	2,532 SF

The Sembler Company | 800.940.6000 | sembler.com

JESSICA MORENO
727.344.8134
JESSICA.MORENO@sembler.com

Although the Sembler Company has obtained the information contained herein from sources it believes to be reliable, and believes the information to be correct, no representations or warranties, express or implied, are made as to the accuracy or reliability of this information. Any references to square footage or age are approximate only. The recipient bears sole responsibility for verification of the accuracy of the information contained herein and bears all risk for any inaccuracies. The Sembler Company shall have no liability or responsibility to any party for any loss or damage arising from reliance by any party on the information contained herein. Site plans subject to change.